



Conference tariff

Standard package p.p

£45.00 - Day delegate rate (inc. room hire)

£150.00 - 24 hour delegate rate (inc. room hire)

Includes:

The 'Working lunch' buffet

3 tea and coffee breaks

Paper and pens

Water and cordials

Executive package p.p

£60.00 - Day delegate rate (inc. room hire)

£165.00 - 24 Hour delegate rate (inc. room hire)

Includes:

Mineral water

3 tea & coffee breaks

The 'Light lunch' buffet with hot main course

Overhead projector and screen

TV with video or DVD

Flip chart and pens

Pastries and fruit in the afternoon

24 hour packages also include single occupancy accommodation, full English breakfast & three course dinner. All delegate rates are per person, based on a minimum of 10 persons and include VAT.

Conference lunch menus

The 'Working lunch' buffet £12.50pp

A selection of freshly prepared sandwiches:

Chicken salad

Tomato, mozzarella and pesto

Roasted Mediterranean vegetable

Ham, cheese and tomato

Smoked salmon with dill mayo

Crudities (carrots, celery, cucumber and peppers) accompanied with two light dips

With your choice of three of the following:

Mediterranean vegetable skewers

Salmon and herbs goujons with herb mayo

Spinach and feta goujons

Prawns in filo pastry with sweet chili sauce

Fresh seasonal fruit and juice

The 'Light lunch' buffet £17.50pp

A selection of cold meats & lite bites including:

Honey roast ham

Flame grilled chicken

Duck spring rolls with hoisin sauce

Chicken tikka skewers with tzatiki

Vegetable spring rolls with soy sauce

With your choice of four of the following salads:

Mixed leaf

Tomato and pesto

Caesar

Rocket and parmesan

Greek

Beetroot and carrot

Couscous with roasted Mediterranean vegetables

New potatoes

Served with warm white and brown rolls

Fresh seasonal fruit salad and juice

Should you wish to include hot food to the above menu please add £5.00pp

Homemade Goan curry with authentic basmati rice

Vegetarian Penne pasta

Filletts of chicken, Madeira sauce, new potatoes and seasonal vegetables

Conference room charges

Room hire only

	KH Suite	Turf Club Suite	Wimbledon Suite
Full day	£550	£450	£250
Half day	£400	£300	£150
Evening	£300	£200	£150

Equipment charges: LCD £100 per day, OHP plus screen £40 per day, flip chart £20 each, TV with video or DVD £20. Room hire only does not include any extras.

Suggested conference room layouts

Maximum capacity in brackets

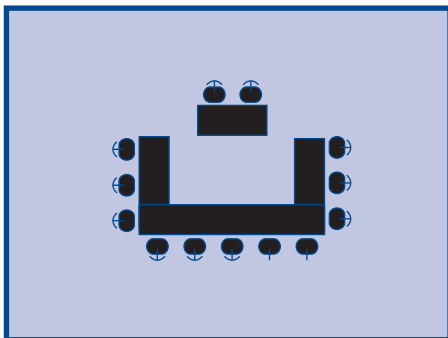

U-shape (30)

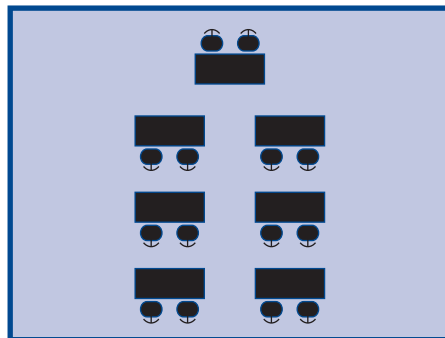

Classroom style (35)

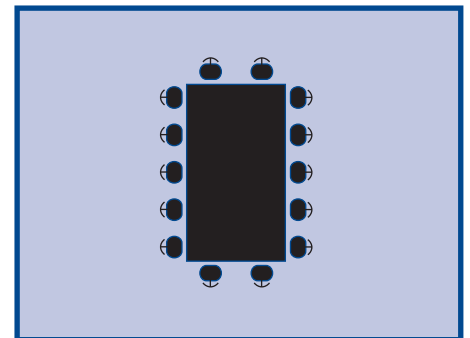

Boardroom style (30)

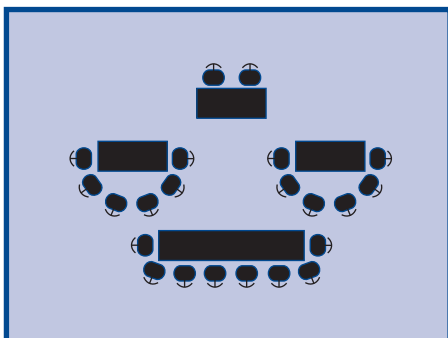

Cabaret (30)

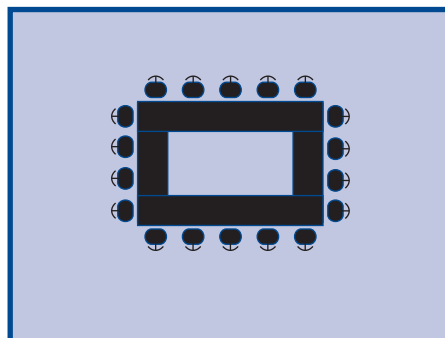

Hollow style (30)

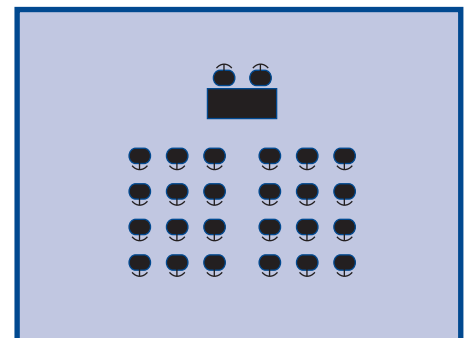

Theatre style (75)

All rooms are equipped with modern conference equipment as well as wireless broadband connectivity. Breakout areas are available, including syndicate rooms, the hotel lounge and Bar 52.

Conference and banqueting suites

The KH Suite

This spacious, light and airy suite is situated on the ground floor overlooking the hotel garden. The room comprises a sound proof partition dividing the suite and the conservatory, which can also be used for your event.

The KH Suite can accommodate any room layout required, seating a maximum of 90 persons (theatre style).

The KH Suite and conservatory are air conditioned and can also be used for dinner dances.

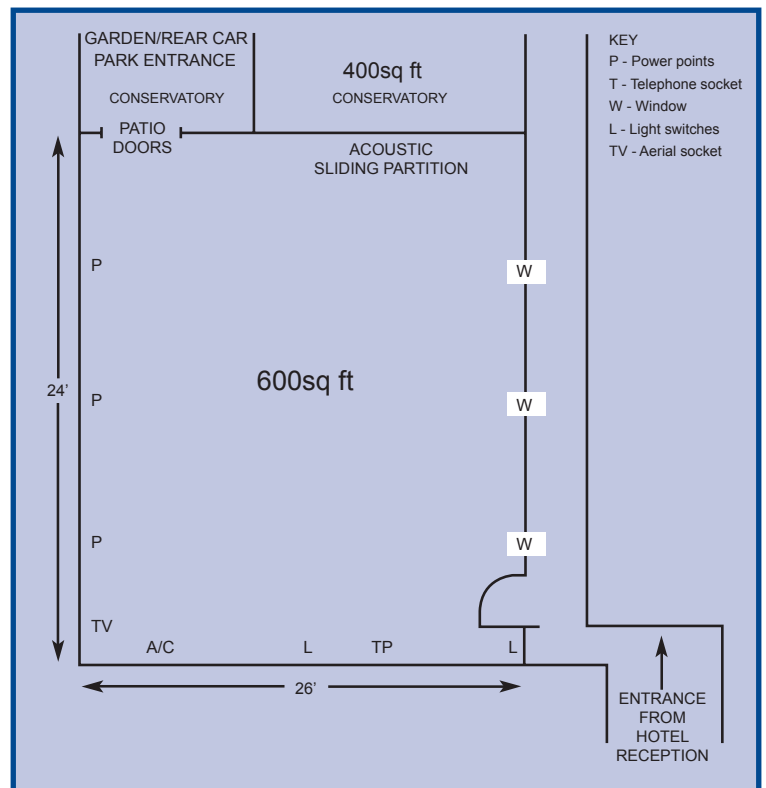

The Turf Club Suite

This stylish room is a mixture of traditional and ultra modern. The high ceiling has an ornate fresco painting and antique chandeliers, while the room also boasts modern glass lighting, funky art, air conditioning and contemporary leather chairs.

It is a flexible suite, ideal for boardroom style management meetings, think-tank sessions, or exclusive private dining. The suite seats up to 25 persons (boardroom) with plenty of space for presentation equipment.

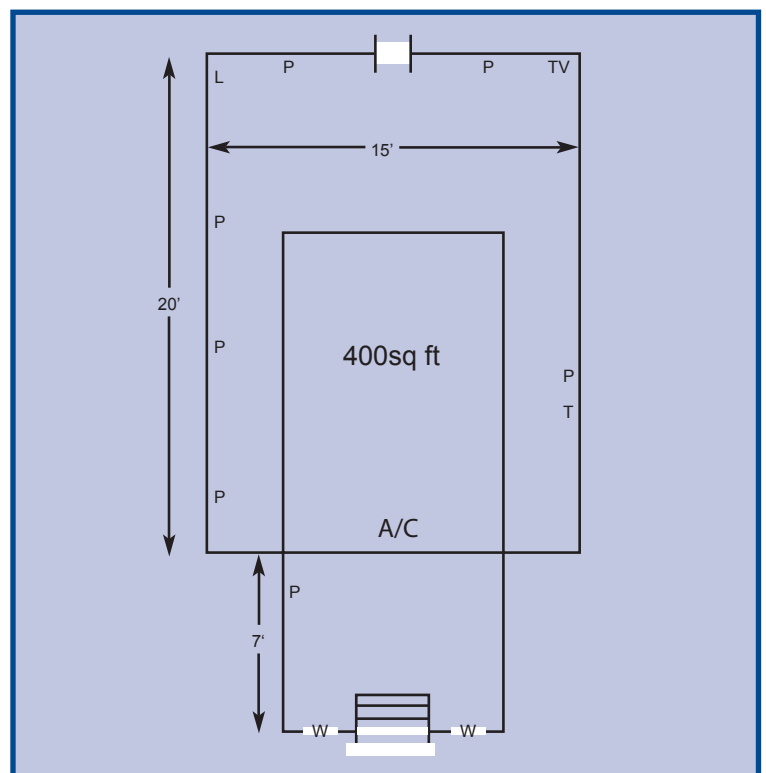

All rooms are equipped with modern conference equipment as well as wireless broadband connectivity. Breakout areas are available, including syndicate rooms, the hotel lounge and Bar 52.

The perfect venue for Conferences